

◆ RID (BALUN Cores)

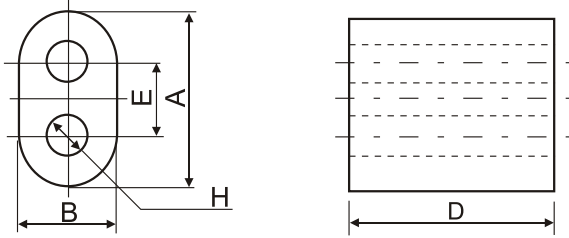

- APPLICATIONS:
1. Rid a circuit of EMI.
 2. Referred to RFI.
 3. Internal and external computer data power cables.
 4. Noise choke.

Type	Dimension(mm)					
	A	B	D	E	H	
RID3.5*2*2*1	3.5±0.15	2.0±0.15	2.0±0.2	1.5	1	
RID6*3*5*1.5	6.0±0.2	3.0±0.15	5.0±0.3	3	1.5	
RID5*3*3*1.2	5.0±0.2	3.0±0.15	3.0±0.3	2	1.2	
RID6.5*3*3*1.2	6.5±0.2	3.0±0.15	3.0±0.3	3.5	1.2	
RID7*4*3*1.5	7.0±0.2	4.0±0.2	3.0±0.3	3	1.5	
RID7.5*2.45*7.85*0.8	7.5±0.2	2.45±0.15	7.85±0.3	5.2	0.85	
RID12*6.1*5*2.7	12.0±0.3	6.1±0.2	5.0±0.3	6.2	2.7	
RID13.3*7.5*14.3*3.7	13.3±0.4	7.5±0.2	14.3±0.3	5.8	3.7	
RID19.43*9.53*19.0*4.75	19.43±0.5	9.53±0.3	19.0±0.4	9.9	4.75	